

SENSE 55 SOCHI 2014 3 cabins - 3 head compartments - 1 Occasional cabin (optional)

EC CERTIFICATE Category A - 10 persons

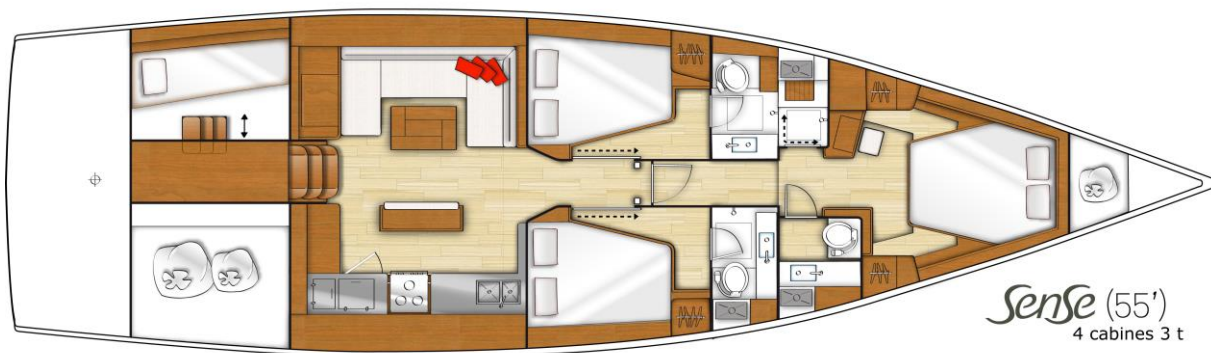

L.O.A	17,20 m 56'5"
Hull length	16,80 m 55'1"
L.W.L.	15,93 m 52'3"
Beam	4,97 m 16'4"
Deep draught (min)	2,35 m 7'9"
Deep ballast weight	4 900 kg 10,800 lbs
Shallow draught (min)	1,80 m 5'11"
Shallow ballast weight	5 500 kg 12,122 lbs
Air draught (max)	23,91 m 78'5"
Light displacement (EC)	18 560 kg 40,906 lbs
Fuel capacity (standard)	415 110 US Gal
Freshwater capacity (standard)	640 169 US Gal
Freshwater capacity (Optional equipment)	330 87 US Gal
Engine power	POD 120
Mainsail (classic)	74 m ² 796 sq ft
Genoa	SELF-TACKING JIB HARDWARE



Inventory list

MOTOR VERSION - YANMAR 4JH4TCE POD 120 DIESEL DOCK + GO (Autopilot and Bow thruster)

TRIM LEVEL - INSPIRATION 2014

Electronic: 1 Multifunction touchscreen e95 LCD (GPS - Chart plotter - Chart reader - Without chart - Cartography Europe included) Starboard steering console

Electronic: 1 i70 Raymarine screen (Loch, Speedometer, Depth sounder) - To port steering console

Electronic: - Multifunction touchscreen e125 LCD - Chart table
Cockpit sole natural solid wood
Galley: 12 V Freezer compartment in 100 L Top-opening icebox
2 service batteries (2 x 140 Amperes x 12 V) + 40 amperes Additional
battery charger
LED: Outside and inside lighting (except deck light)
Indirect LED lighting under high cupboards
Shore freshwater supply
Galley: Freshwater purifier
1 Port electric coachroof winch H50.2 STECH
Inner forestay chainplate
Multimedia system: Radio CD/DVD PIONEER - Speakers BOSE ACOUSTIMASS® 3 -
Outside loudspeakers SONY
Motorised glazed folding companionway door in cockpit floor - 2 Remote controls
Textile storage with 2 steering consoles

PACK ELECTRONIC 2014

To port steering console: 1 Multifunction touchscreen e95 LCD (GPS - Chart plotter -
Chart reader - Without chart - Cartography Europe included)
Starboard steering console: 1 i70 screen (Windvane - Anemometer)
Wifi interface

2 FLAG HALYARDS

ELECTRIC GENOA SHEET WINCHES H60.2STCE/60.STC

ELECTRIC STARBOARD COACHROOF WINCH H46.2STCEH/46.2STC

GRAPHITE COACHROOF SPRAYHOOD

GRAPHITE COCKPIT BIMINI

NATTE STONE & QUADRI GREY OUTSIDE UPHOLSTERY

ADDITIONAL WATER TANK (330 LITERS)

GENERATOR 7 KVA 220V 50HZ - WITH COCOON

MICROWAVE OVEN 220V

ICE MAKER 220V 50HZ

CHILLED WATER AIR CONDITIONING 30000 BTU 220V 50HZ

ELECTRIC TOILET QUIET FLUSH CENTRAL PORTSIDE

ELECTRIC TOILET QUIET FLUSH STARBOARD FORWARD + HOLDING TANK

ELECTRIC TOILET QUIET FLUSH CENTRAL STARBOARD+ HOLDING TANK

EXTRA FUEL TANK (415 LITERS)

3 FOLDING BLADES PROPELLER (DOCK & GO)

32"TV + DVD-MP3-CD PLAYER IN SALOON

RADAR HIGH DEFINITION (RADOME ONLY)

WINDEX WINDVANE